

Model B-DBI-1



The **Berry Automatic Double Box Icer** is used to ice product in 70 pound tubs or boxes on a moving box conveyor, two lines at once. The amount of ice needed can be set to your application.

Berry Double Box Icer

ELECTRICITY:	2—1-1/2 H.P. ELECTRIC MOTORS
CAPACITY:	DETERMINED BY LINE SPEED
HEIGHT:	APPROXIMATELY 83 1/2"
WIDTH:	APPROXIMATELY 60"
DEPTH:	APPROXIMATELY 95 1/2"

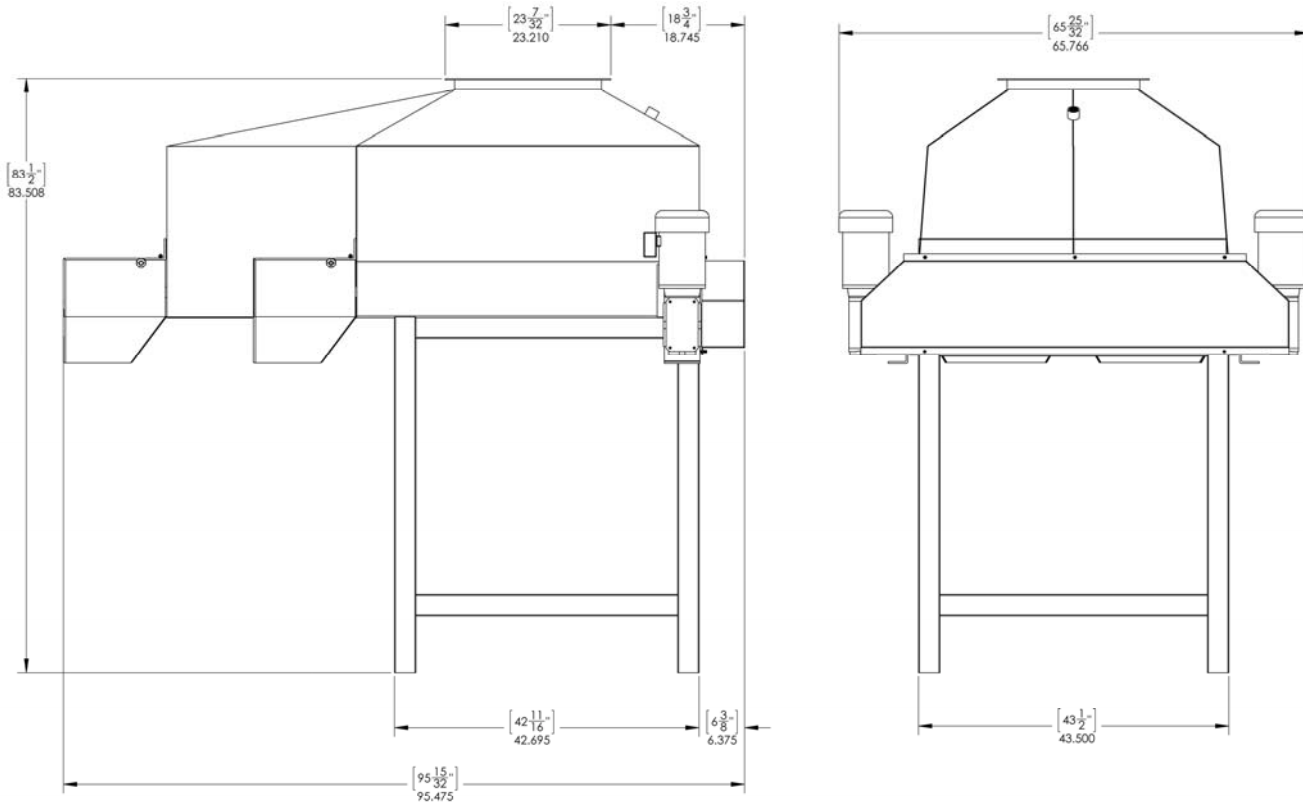

Maintenance:

Designed for minimum maintenance, little is required other than daily cleaning, and regular greasing of bearings and checking gear box oil level.